



### Specifications

Model	4R110-06	4R210-06	4R210-08	4R310-08	4R310-10
Fluid	Air (to be filtered by 40 μm filter element)				
Operating	Manual control direct acting tube				
Port size ①	PT1/8		PT1/4		PT3/8
Orifice size	12.0mm <sup>2</sup> (Cv=0.67)	14.0mm <sup>2</sup> (Cv=0.78)	16.0mm <sup>2</sup> (Cv=0.89)	25.0mm <sup>2</sup> (Cv=1.39)	30.0mm <sup>2</sup> (Cv=1.67)
Valve type	5/2 Way				
Lubrication ②	Not required				
Pressure range	0~1.0MPa(0~145psi)				
Proof pressure	1.5MPa(215psi)				
Temperature	-20~70°C				
Material body	Aluminum alloy				

- ① PT thread, G thread and NPT thread are available;  
 ② Once lubricated air is used, continue with same medium to optimise valve life span.  
 It is suggested to use ISO Vg32 lubricant or the oil with the same grade.

### Symbol



### Ordering code

<b>4R</b>	<b>2</b>	<b>10</b>	<b>08</b>	<input type="checkbox"/>
<b>Model</b>	<b>Valve type</b>	<b>Port size</b>	<b>Thread type</b>	
4R 5 port 2 position push-pull valve	10 2 position	Code Port size	Blank PT	
<b>Code</b>		100 Series 06 1/8"	G G	
1 100 Series		200 Series 06 1/8"	T NPT	
2 200 Series		300 Series 08 1/4"		
3 300 Series		300 Series 10 3/8"		

### Inner structure

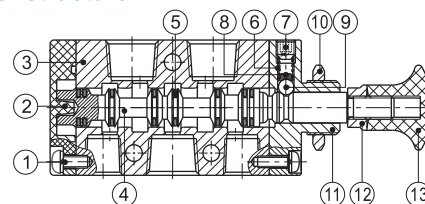

No.	Item	No.	Item	No.	Item
1	Round head screw	6	Spring	11	Top cover
2	Bottom cover	7	Stop screw	12	Safety nut
3	Body	8	Spring base	13	Hand grip
4	Spool	9	Steel ball	14	
5	O-ring	10	Hexagon nut		

### Flow chart

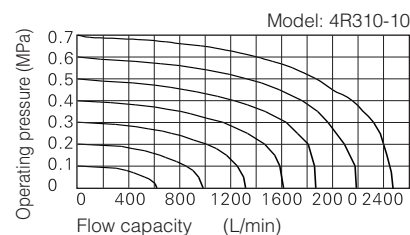
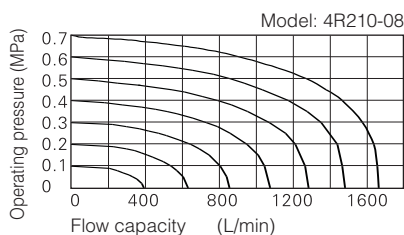
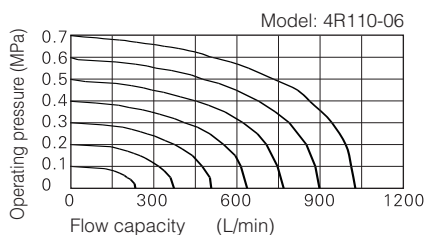

### Dimensions

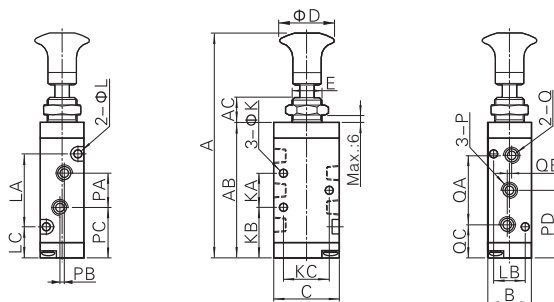

Model/Item	A	AB	AC	B	C	D	E	K	KA	KB	KC	L	LA	LB	LC	P	PA	PB	PC	PD	Q	QA	QB	QC
4R110-06	98	58.8	10	18	27	25	M12×0.75	3.3	14	22	19	3.3	30	13	14	PT1/8	16	3	21	29	PT1/8	28	2	15
4R210-06	106	65.8	10	22	35	25	M14×1	4.3	20	22.5	23.5	3.3	38	17	13.5	PT1/8	18	0	23.5	32.5	PT1/8	36	0	14.5
4R210-08	106	65.8	10	22	35	25	M14×1	4.3	20	22.5	23.5	3.3	38	17	13.5	PT1/8	21	3	22	32.5	PT1/4	36	0	14.5
4R310-08	121.5	81	10	27	40	25	M16×1	4.3	24	28.5	27.5	4.3	50	20	15.5	PT1/4	22	0	29.5	40.5	PT1/4	45	0	18
4R310-10	121.5	81	10	27	40	25	M16×1	4.3	24	28.5	27.5	4.3	50	20	15.5	PT1/4	24	4	28.5	40.5	PT3/8	45	0	18